

# Memory Module Specifications

## KSM26SED8/32HA

32GB 2Rx8 4G x 72-Bit PC4-2666

CL19 260-Pin ECC SODIMM

### DESCRIPTION

Kingston's KSM26SED8/32HA is a 4G x 72-bit (32GB) DDR4-2666 CL19 SDRAM (Synchronous DRAM) w/ parity, 2Rx8, ECC, memory module, based on eighteen 2G x 8-bit FBGA components. The SPD is programmed to JEDEC standard latency DDR4-2666 timing of 19-19-19 at 1.2V. Each 260-pin SODIMM uses gold contact fingers. The electrical and mechanical specifications are as follows:

### FEATURES

- Power Supply: VDD = 1.2V
- VDDQ = 1.2V
- VPP = 2.5V
- VDDSPD = 2.20V to 3.60V
- Functionality and operations comply with the DDR4 SDRAM datasheet
- 16 internal banks
- Bank Grouping is applied, and CAS to CAS latency (tCCD\_L, tCCD\_S) for the banks in the same or different bank group accesses are available
- Data transfer rates: PC4-2666, PC4-2400, PC4-2133, PC4-1866, PC4-1600
- Bi-Directional Differential Data Strobe
- 8 bit pre-fetch
- Burst Length (BL) switch on-the-fly BL8 or BC4(Burst Chop)
- Supports ECC error correction and detection
- On-Die Termination (ODT)
- Temperature sensor with integrated SPD
- This product is in compliance with the RoHS directive.
- Per DRAM Addressability is supported
- Internal Vref DQ level generation is available
- Write CRC is supported at all speed grades
- CA parity (Command/Address Parity) mode is supported
- RoHS Compliant and Halogen-Free

### SPECIFICATIONS

CL(IDD)	19 cycles
Row Cycle Time (tRCmin)	45.75ns(min.)
Refresh to Active/Refresh Command Time (tRFCmin)	350ns(min.)
Row Active Time (tRASmin)	32ns(min.)
Maximum Operating Power	*
UL Rating	94 V - 0
Operating Temperature	0° C to +85° C
Storage Temperature	-55° C to +100° C

\*See IDD Specifications (page 2)

### Module Assembly

<b>DRAM: HYNIX (A-DIE)</b>
----------------------------

Continued >>

## IDD Specifications

IDD		unit
Symbol	2666	
IDD0	722	mA
IDD0A	723	mA
IDD1	789	mA
IDD1A	816	mA
IDD2N	642	mA
IDD2NA	644	mA
IDD2NT	729	mA
IDD2NL	439	mA
IDD2NG	633	mA
IDD2ND	616	mA
IDD2NP	661	mA
IDD2P	424	mA
IDD2Q	590	mA
IDD3N	969	mA
IDD3NA	969	mA
IDD3P	767	mA
IDD4R	1502	mA
IDD4RA	1523	mA
IDD4RB	1515	mA
IDD4W	1337	mA
IDD4WA	1377	mA
IDD4WB	1283	mA
IDD4WC	1333	mA
IDD4WP	1569	mA
IDD5B	3852	mA
IDD5F2	2785	mA
IDD5F4	2354	mA
IDD6N	588	mA
IDD6E	887	mA
IDD6R	332	mA
IDD6A	886	mA
IDD7	1581	mA
IDD8	249	mA

IPP		unit
Symbol	2666	
IPP0	31	mA
IPP1	31	mA
IPP2N	25	mA
IPP2P	25	mA
IPP3N	35	mA
IPP3P	35	mA
IPP4R	30	mA
IPP4W	30	mA
IPP5B	603	mA
IPP5F2	401	mA
IPP5F4	330	mA
IPP6N	76	mA
IPP6E	129	mA
IPP6R	39	mA
IPP6A	114	mA
IPP7	87	mA
IPP8	25	mA

## MODULE DIMENSIONS

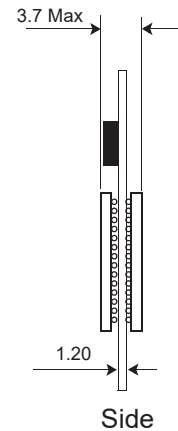
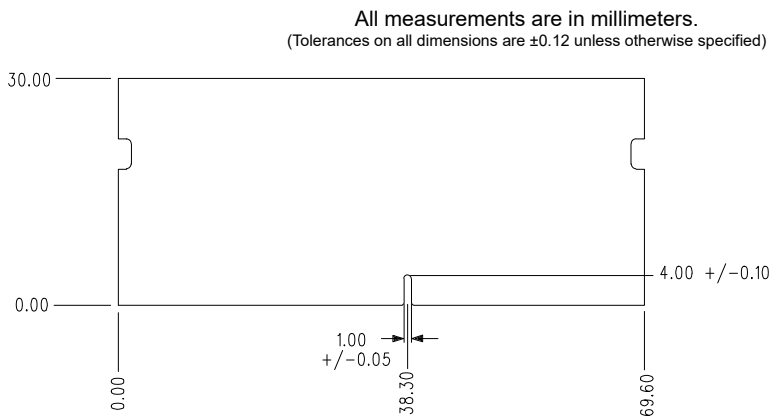
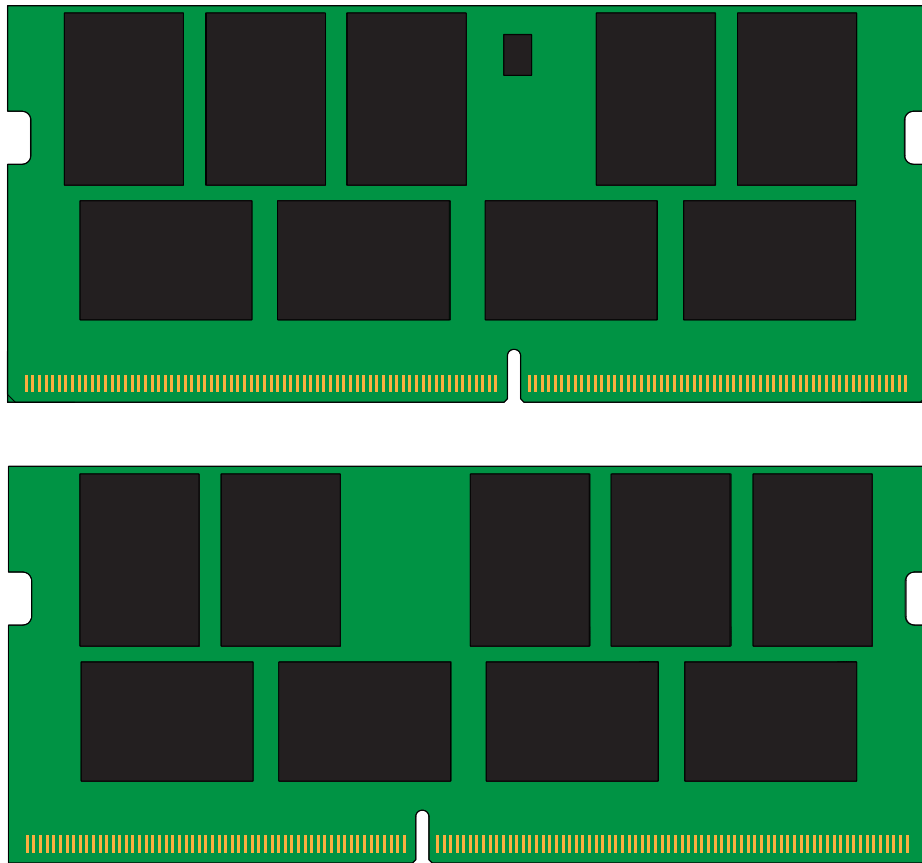

The product images shown are for illustration purposes only and may not be an exact representation of the product. Kingston reserves the right to change any information at anytime without notice.