

# Memory Module Specifications

## KSM26RD8/16HCI

16GB 2Rx8 2G x 72-Bit PC4-2666

CL19 Registered w/Parity 288-Pin DIMM

### DESCRIPTION

Kingston's KSM26RD8/16HCI is a 2G x 72-bit (16GB) DDR4-2666 CL19 SDRAM (Synchronous DRAM) registered w/ parity, 2Rx8, ECC, memory module, based on eighteen 1G x 8-bit FBGA components. The SPD is programmed to JEDEC standard latency DDR4-2666 timing of 19-19-19 at 1.2V. Each 288-pin DIMM uses gold contact fingers. The electrical and mechanical specifications are as follows:

### FEATURES

- Power Supply: VDD = 1.2V
- VDDQ = 1.2V
- VPP = 2.5V
- VDDSPD = 2.41V to 2.75V
- Functionality and operations comply with the DDR4 SDRAM datasheet
- 16 internal banks
- Bank Grouping is applied, and CAS to CAS latency (tCCD\_L, tCCD\_S) for the banks in the same or different bank group accesses are available
- Data transfer rates: PC4-2666, PC4-2400, PC4-2133, PC4-1866, PC4-1600
- Bi-Directional Differential Data Strobe
- 8 bit pre-fetch
- Burst Length (BL) switch on-the-fly BL8 or BC4(Burst Chop)
- Supports ECC error correction and detection
- On-Die Termination (ODT)
- Temperature sensor with integrated SPD
- This product is in compliance with the RoHS directive.
- Per DRAM Addressability is supported
- Internal Vref DQ level generation is available
- Write CRC is supported at all speed grades
- CA parity (Command/Address Parity) mode is supported

### SPECIFICATIONS

CL(IDD)	19 cycles
Row Cycle Time (tRCmin)	46.25ns(min.)
Refresh to Active/Refresh Command Time (tRFCmin)	350ns(min.)
Row Active Time (tRASmin)	32ns(min.)
Maximum Operating Power	*
UL Rating	94 V - 0
Operating Temperature	0° C to +85° C
Storage Temperature	-55° C to +100° C

\* See IDD Table (page 2)

### Module Assembly

<b>DRAM:</b> HYNIX (C-DIE)
<b>RCD:</b> IDT

Continued >>

## IDD Specifications

IDD		unit
Symbol	2666	
IDD0	1084	mA
IDD0A	1093	mA
IDD1	1218	mA
IDD1A	1245	mA
IDD2N	103	mA
IDD2NA	1003	mA
IDD2NT	1093	mA
IDD2NL	877	mA
IDD2NG	1003	mA
IDD2ND	985	mA
IDD2NP	1003	mA
IDD2P	673	mA
IDD2Q	949	mA
IDD3N	1183	mA
IDD3NA	1183	mA
IDD3P	871	mA
IDD4R	1929	mA
IDD4RA	1956	mA
IDD4RB	1947	mA
IDD4W	1767	mA
IDD4WA	1803	mA
IDD4WB	1713	mA
IDD4WC	1749	mA
IDD4WP	1920	mA
IDD5B	2524	mA
IDD5F2	2047	mA
IDD5F4	1912	mA
IDD6N	400	mA
IDD6E	526	mA
IDD6R	274	mA
IDD6A	526	mA
IDD7	2109	mA
IDD8	238	mA

IPP		unit
Symbol	2666	
IPP0	78	mA
IPP1	87	mA
IPP2N	58	mA
IPP2P	58	mA
IPP3N	288	mA
IPP3P	288	mA
IPP4R	200	mA
IPP4W	200	mA
IPP5B	596	mA
IPP5F2	398	mA
IPP5F4	344	mA
IPP6N	90	mA
IPP6E	126	mA
IPP6R	74	mA
IPP6A	126	mA
IPP7	191	mA
IPP8	58	mA

## MODULE DIMENSIONS

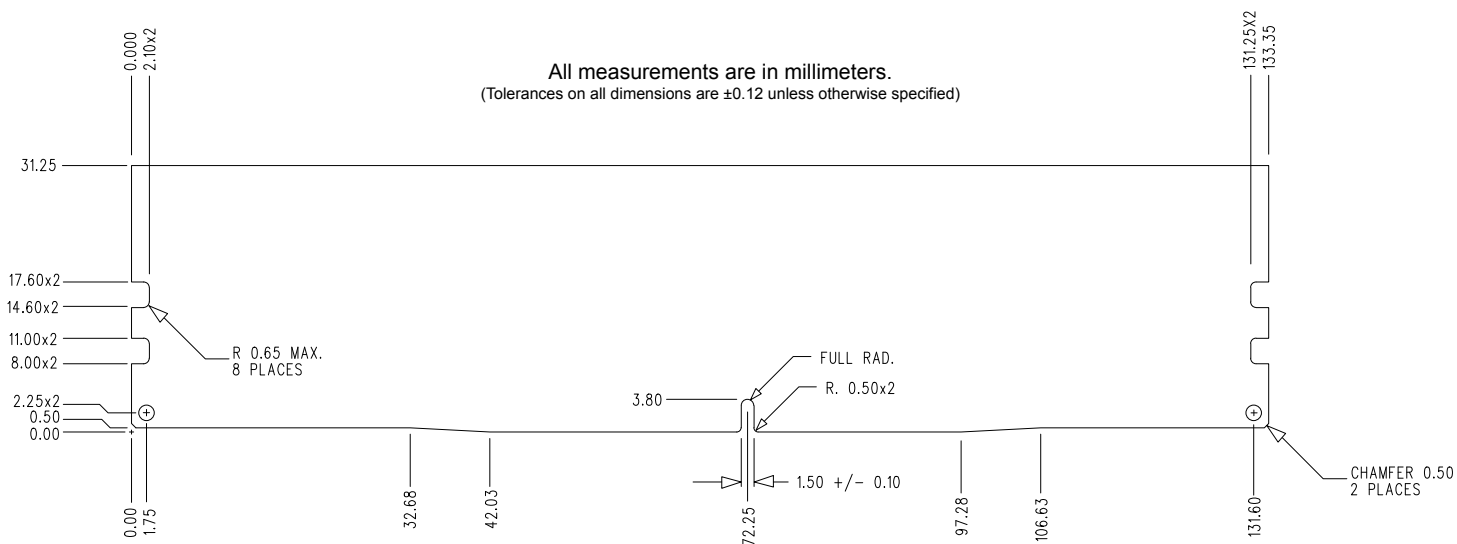
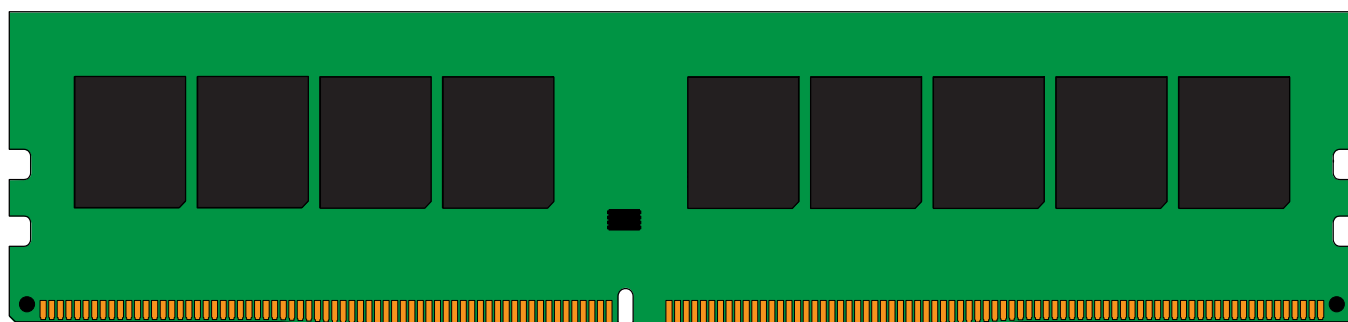
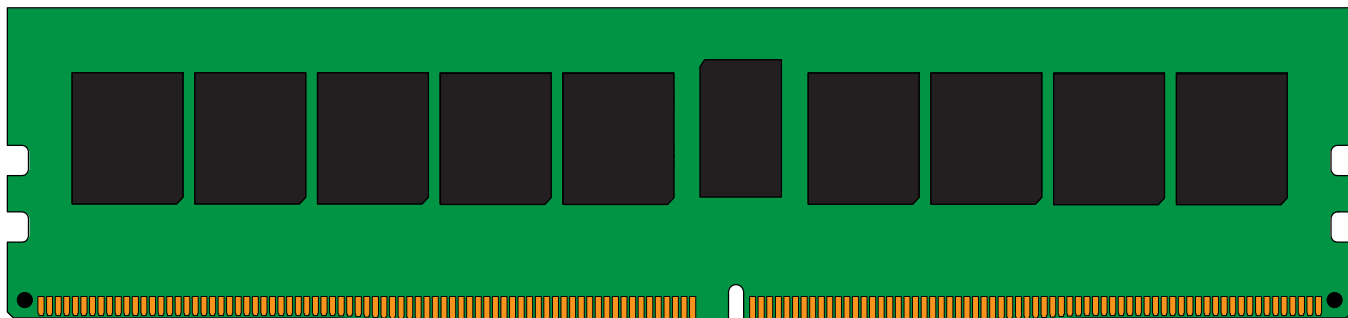

The product images shown are for illustration purposes only and may not be an exact representation of the product. Kingston reserves the right to change any information at anytime without notice.